



Loomis Park

PEN1144385-01-03 • 04.13.2020





Loomis Park

PEN1144385-01-03 • 04.13.2020



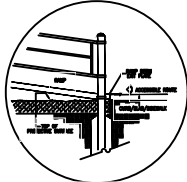

SUGGESTED RAMP BERM EXIT PLATE
8 7/12" DECK TO GRADE/DB INSTALLATION
REFER TO RAMP BERM EXIT PLATE INSTALLATION SHEET

Legend

1	100' Round Platform
2	100' Round Platform
3	100' Round Platform
4	100' Round Platform
5	100' Round Platform
6	100' Round Platform
7	100' Round Platform
8	100' Round Platform
9	100' Round Platform
10	100' Round Platform
11	100' Round Platform
12	100' Round Platform
13	100' Round Platform
14	100' Round Platform
15	100' Round Platform
16	100' Round Platform
17	100' Round Platform
18	100' Round Platform
19	100' Round Platform
20	100' Round Platform
21	100' Round Platform
22	100' Round Platform
23	100' Round Platform
24	100' Round Platform
25	100' Round Platform
26	100' Round Platform
27	100' Round Platform

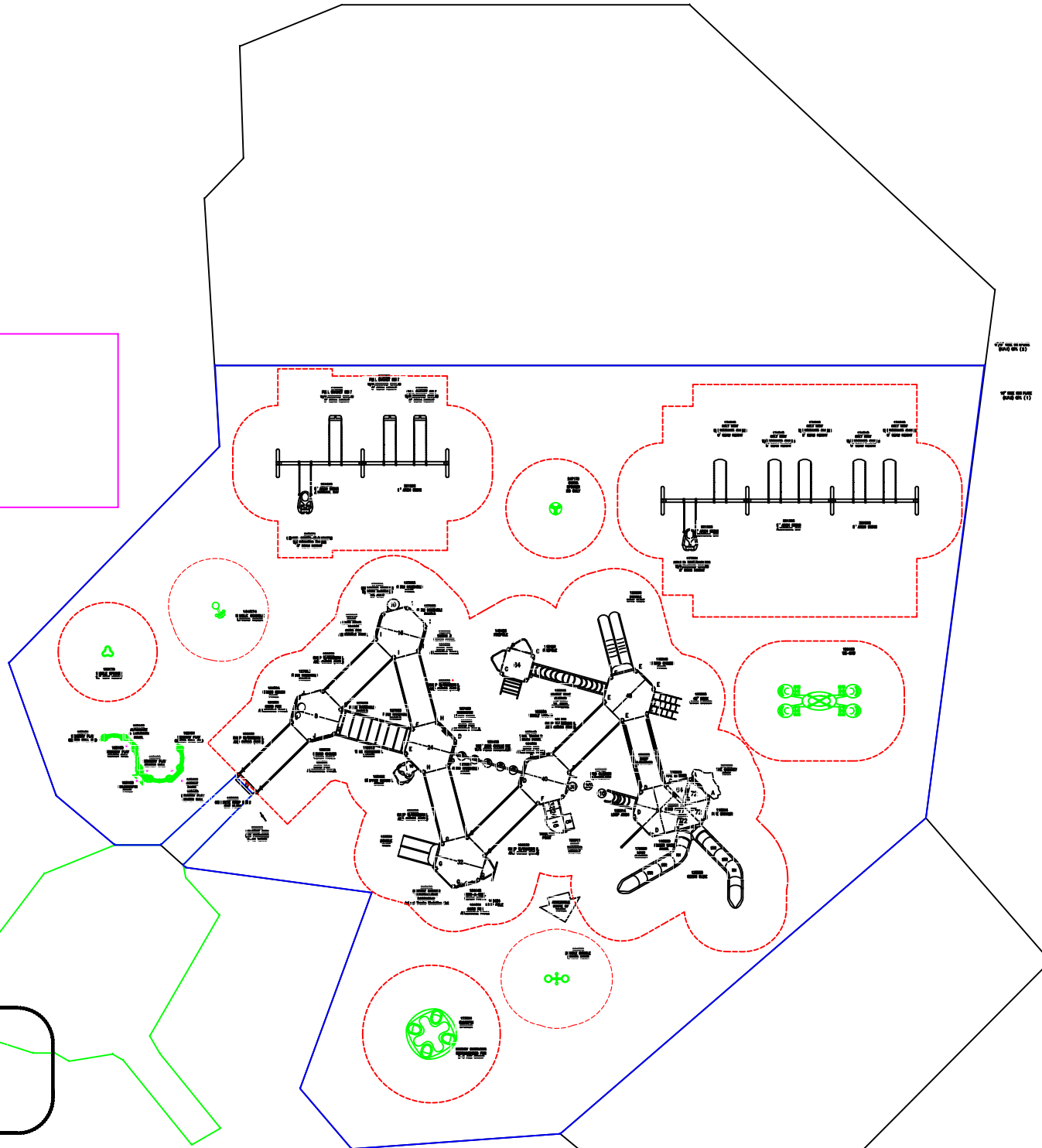

PHASE 1

TOTAL ELEVATED PLAY COMPONENTS	27		
TOTAL ELEVATED COMPONENTS ACCESSIBLE BY RAMP	20	REQUIRED	14
TOTAL ELEVATED COMPONENTS ACCESSIBLE BY TRANSFER	3	REQUIRED	0
TOTAL ACCESSIBLE GROUND LEVEL COMPONENTS SHOWN	9	REQUIRED	2
TOTAL DIFFERENT TYPES OF GROUND LEVEL COMPONENTS	4	REQUIRED	4

PHASE 1 & 2

TOTAL ELEVATED PLAY COMPONENTS	27		
TOTAL ELEVATED COMPONENTS ACCESSIBLE BY RAMP	20	REQUIRED	14
TOTAL ELEVATED COMPONENTS ACCESSIBLE BY TRANSFER	3	REQUIRED	0
TOTAL ACCESSIBLE GROUND LEVEL COMPONENTS SHOWN	18	REQUIRED	2
TOTAL DIFFERENT TYPES OF GROUND LEVEL COMPONENTS	7	REQUIRED	7

TOTAL SQUARE FOOTAGE
9920 SQ. FT.

PlayBooster®
(5-12 years)

Max Fall Height: 108 inches

landscape structures



The play components identified on this plan are IPEMA certified. (Unless model number is preceded with *) The use and layout of these components conform to the requirements of ASTM F1487. To verify product certification, visit www.ipema.org

THIS PLAY AREA & PLAY EQUIPMENT IS DESIGNED FOR AGES 2-12 YEARS UNLESS OTHERWISE NOTED ON PLAN.

IT IS THE MANUFACTURERS OPINION THAT THIS PLAY AREA DOES CONFORM TO THE A.D.A. ACCESSIBILITY STANDARDS, ASSUMING AN ACCESSIBLE PROTECTIVE SURFACING IS PROVIDED, AS INDICATED, OR WITHIN THE ENTIRE USE ZONE.

THIS CONCEPTUAL PLAN WAS BASED ON INFORMATION AVAILABLE TO US. PRIOR TO CONSTRUCTION, DETAILED SITE INFORMATION INCLUDING SITE DIMENSIONS, TOPOGRAPHY, EXISTING UTILITIES, SOIL CONDITIONS, AND DRAINAGE SOLUTIONS SHOULD BE OBTAINED, EVALUATED, & UTILIZED IN THE FINAL DESIGN. PLEASE VERIFY ALL DIMENSIONS OF PLAY AREA, SIZE, ORIENTATION, AND LOCATION OF ALL EXISTING UTILITIES, EQUIPMENT, AND SITE FURNISHINGS PRIOR TO ORDERING. SLIDES SHOULD NOT FACE THE HOT AFTERNOON SUN.

CHOOSE A PROTECTIVE SURFACING MATERIAL THAT HAS A CRITICAL HEIGHT VALUE TO MEET THE MAXIMUM FALL HEIGHT FOR THE EQUIPMENT (REF. ASTM F1487 STANDARD CONSUMER SAFETY PERFORMANCE SPECIFICATION FOR PLAYGROUND EQUIPMENT FOR PUBLIC USE, SECTION 8 CURRENT REVISION). THE SUBSURFACE MUST BE WELL DRAINED. IF THE SOIL DOES NOT DRAIN NATURALLY IT MUST BE TILED OR SLOPED 1/8" TO 1/4" PER FOOT TO A STORM SEWER OR A "FRENCH DRAIN".

DESIGNED BY:
VC

COPYRIGHT:
LANDSCAPE STRUCTURES, INC.
601 7th STREET SOUTH - P.O. BOX 198
DELANO, MINNESOTA 55328
PH: 1-800-328-0035 FAX: 1-763-972-6091

Date	Previous Drawing #	Initials

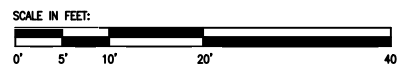

Loomis Park
Jackson, MI

Penchura LLC
Jennifer Smith

SYSTEM TYPE:
PlayBooster
DRAWING #:
PEN1144385-02





Make all P.O.s, Contracts, and Checks to:
Penchura, L.L.C.
889 S. Old US 23
Brighton, MI 48114

Proposal

Date	Project #
8/18/2020	20-339-4

Bill To
City of Jackson Parks & Rec 161 W. Michigan Ave. Jackson, MI 49201

Ship To
Loomis Park

Customer Contact	Customer Phone	Customer Fax	Terms	P.O. No.	Rep
Tom Steiger	517-788-4040	517-768-5860	Net 30		JRS

Item	Description	Qty	Weight	Price	Total
Custom	PlayBooster Structure	1		122,490.00	122,490.00
discount	8% Purchasing Program Discount			-8.00%	-9,799.20
Freight	Freight	1		7,498.00	7,498.00
EWf-I	Engineered Wood Fiber - Installed	460		33.00	15,180.00
Install	Installation with Superior Recreation	1		35,000.00	35,000.00
	Does Not Include Removal of Existing Structure, Excavation, or Site Restoration				

Proposal good for 30 days.
 Ship Via: common carrier
 Delivery contact name and number: _____

Customer signature below constitutes a purchase order.

Subtotal	\$170,368.80
Sales Tax (0.0%)	\$0.00
Total	\$170,368.80