

Jackson Public Arts Commission
Martin Luther King Jr. Blvd Roundabout
Sculpture

Project Details

Table of contents:

Sculpture Specifications

Timeline

Budget / Payment Schedule

Insurance (example)

Site Specifications

Finished Sculpture Designs

Conceptual Sculpture Designs

Sculpture Specifications

Process and Fabrication Description

The fabrication process or work plan is comprised of several process implemented at the same time. Everything starts at the drafting of the sculpture installation. From the initial design, the refinement and scaling of the design comes into place. Once that has been established, the process of scaling design follows. Upon completion of the finalized designs, fabrication commences. Materials, vendors and assistance will be engaged. Individual components will be fabricated and assembled into the final sculpture. In conjunction with this process, site visits and consultations with the JPAC team about the foundation and progress updates will occur as necessary. Design elements and weight determinations will be forwarded as the fabrication progresses. Once the fabrication process is completed, the sculptures undergo a finishing phase before the coating process.

During fabrication, the site foundation and preparation continues with advice and consultations with the contractors and city. After inspection and approval of the foundation and installation pad has been received from the city and JPAC representatives, transportation for delivery of the final pieces from the powder coater will be scheduled for delivery to the studio for final assembly and then proceed to the site. The sculptures will be delivered and installed under my supervision, in coordination with the City of Jackson Building and Engineering inspectors. Following MiOSHA regulations and procedures the sculptures will be installed. Collaborating with the JPAC team, suggestions for lighting the pieces, and final landscaping design is completed. A final check and polishing will occur before acceptance.

Jackson Public Arts Commission
Martin Luther King Jr. Blvd-Roundabout Sculpture
Project Committee

Timeline:

January 2023

Project Confirmation
Insurance
Contract
Permits/Excavation (Foundation)
Begin fabrication process

February

JPAC/MLKRS project updates (meetings-studio visits).
Fabrication continues
Site visit (confirm foundation specs).
Attachment bolts with subgrade anchors.

March

JPAC/MLKRS project updates (site visits-logistics).
Prepare and pouring of sculpture foundation/curing time
Fabrication continues
Metal finishing stage begins
Above grade galvanized pedestals (fabricating).

April

Powdercoating/Exterior finishing of sculptures
Site preparation

JPAC/MLKRS updates (finishing/installation/transportation).

April/May

Finishing/installation

Transport finished sculptures to site for installation.

Careful packing and securing of all related components and installation equipment.

Finished sculptures installed.

Final inspection and sign off

Project completion

Jackson Public Arts Commission
Martin Luther King Jr. Blvd-Roundabout Sculpture
Project Committee

Budget:

| | |
|---|--------------|
| Permits,accounting,logistics and legal. | \$4500 |
| Design,Artwork purchase,operating costs. | \$11,000 |
| Materials,fabrication equipment,consumables. | \$5000 |
| Installation,site preparation,labor. | \$4000 |
| Transportation,outsourcing,ect. | \$2500 |
| Equipment,specific tools required. | \$1000 |
| Finishing process,galvanizing,powder coating. | |
| Budget Grand Total: | \$30,000 |

Payment schedule:

50% of total budget (\$15,000) is required to begin the fabrication and construction process.

25% of remaining balance (\$7500) will be required towards the halfway point of the project.

25% of the total budget which is the balance (\$7500) will be required upon completion of the project installation and agreement of JPAC and MLKRS Project Committee

This budget payment schedule has been made specifically for this project.

Thank you.



* FOUNDATIONS
↓
DETAILS

PLAN VIEW

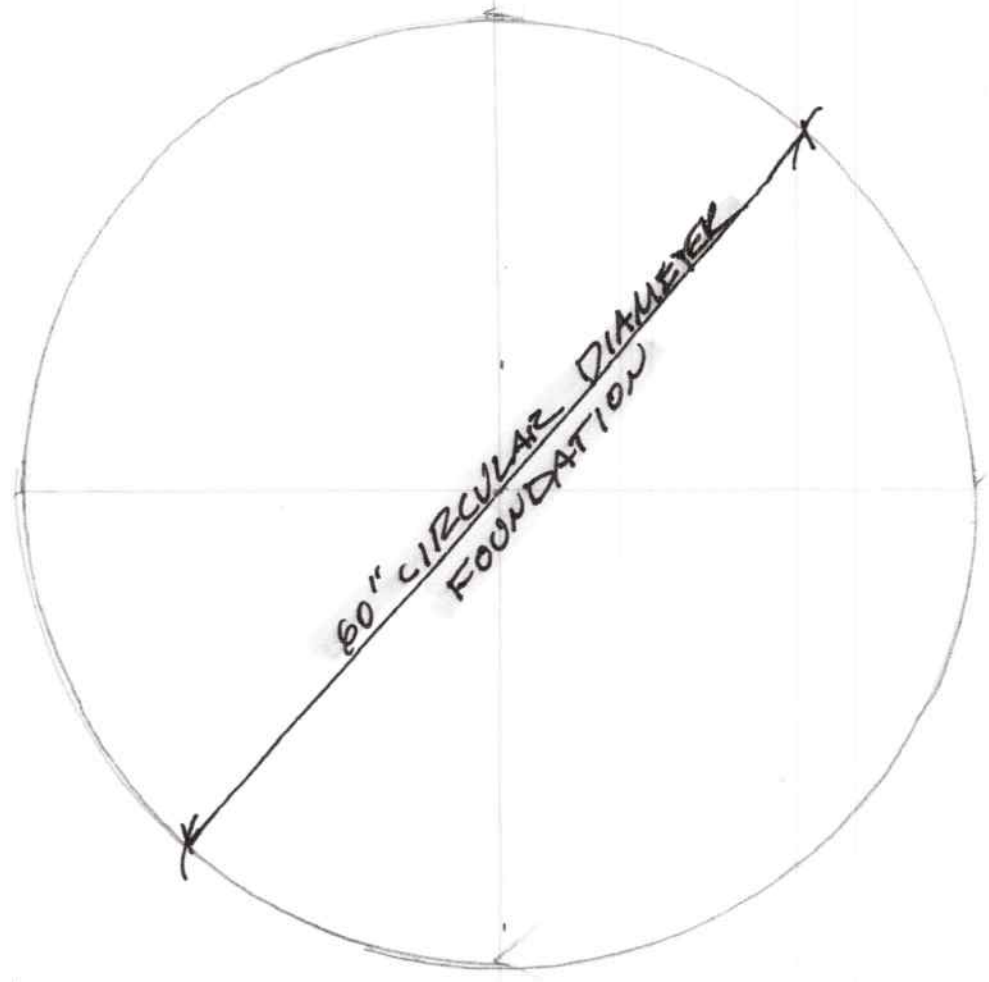

ABOVE GRADE
6"

42"

BELOW GRADE

LEVEL CONCRETE SURFACE

ELEVATION

FROST LINE @ 42" DEPTH

48" TOTAL

ABOVE GRADE
6"



③ GALVANIZED 1/4" THICK SCULPTURE PEDISTALS

* GALVANIZED MOUNTS
48" TALL EACH

* ADDRESSES
SAFETY ISSUES

* LIGHTING OPTIONS:
(CENTER)
(PERIMETER)
TBD

* SCULPTURE MOUNTS
VIA HEAVY DUTY
NON-FERROUS HARDWARE

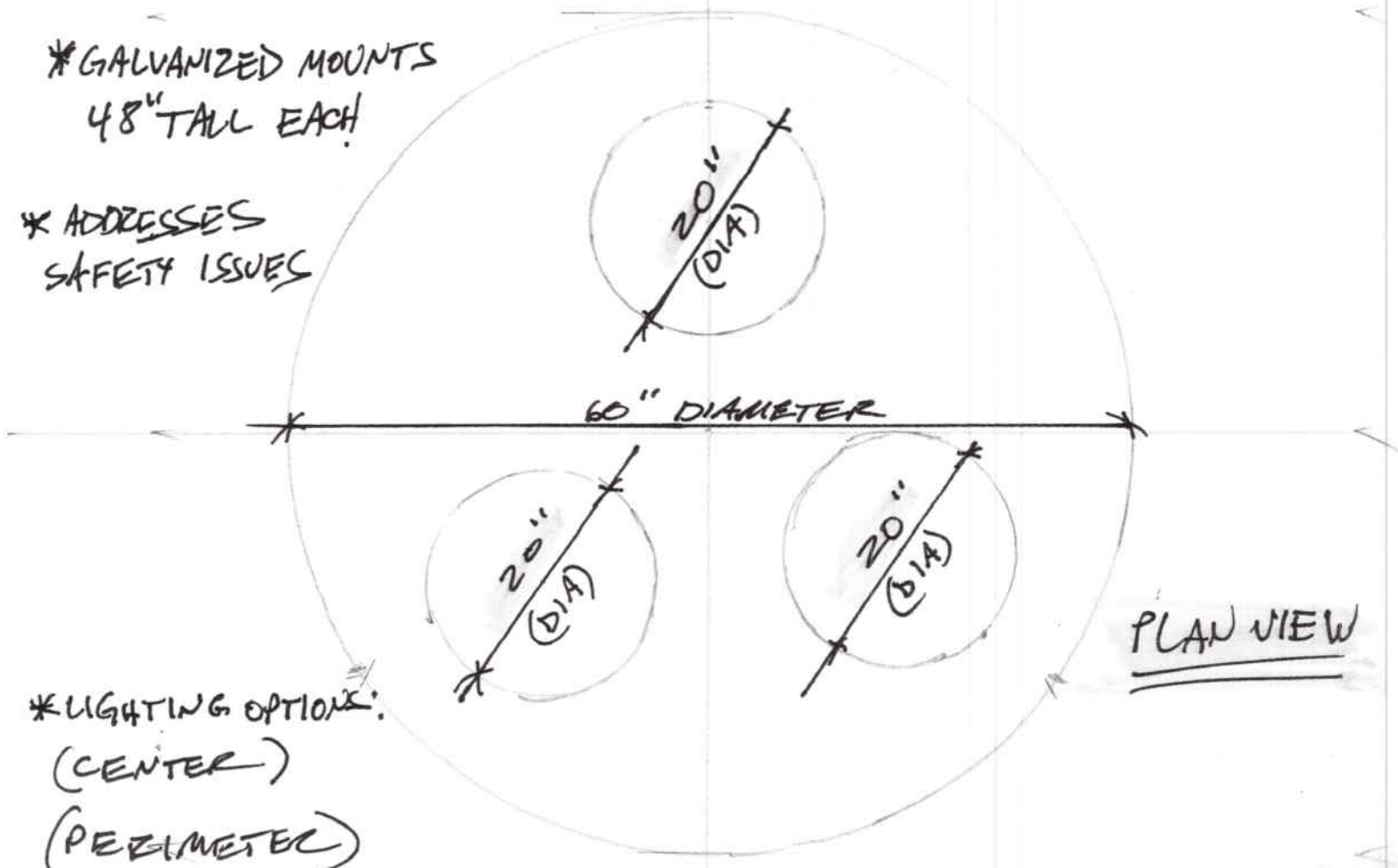

PLAN VIEW

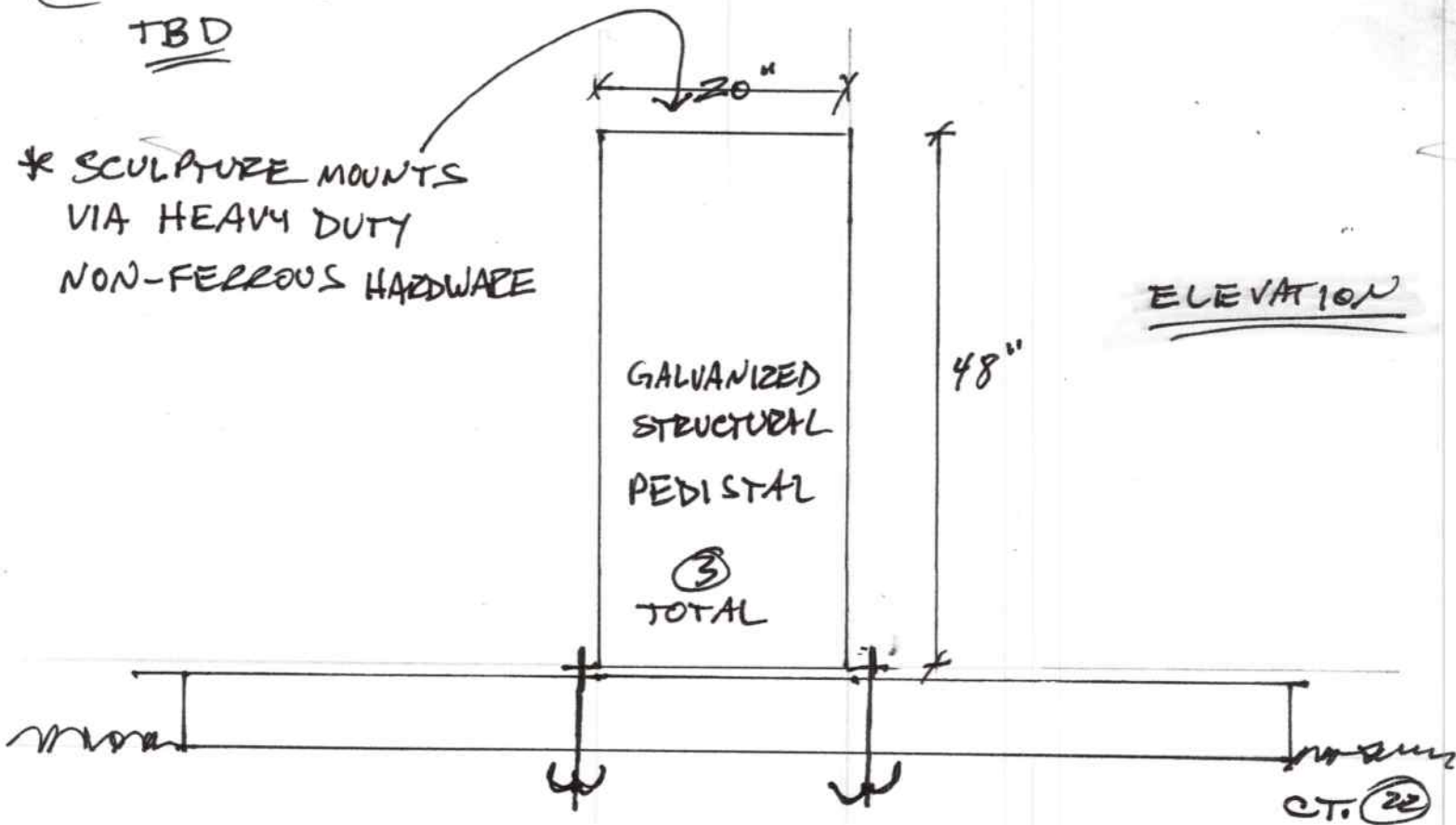

ELEVATION

VARIABLES (66'-201') ROW

DIAMETER

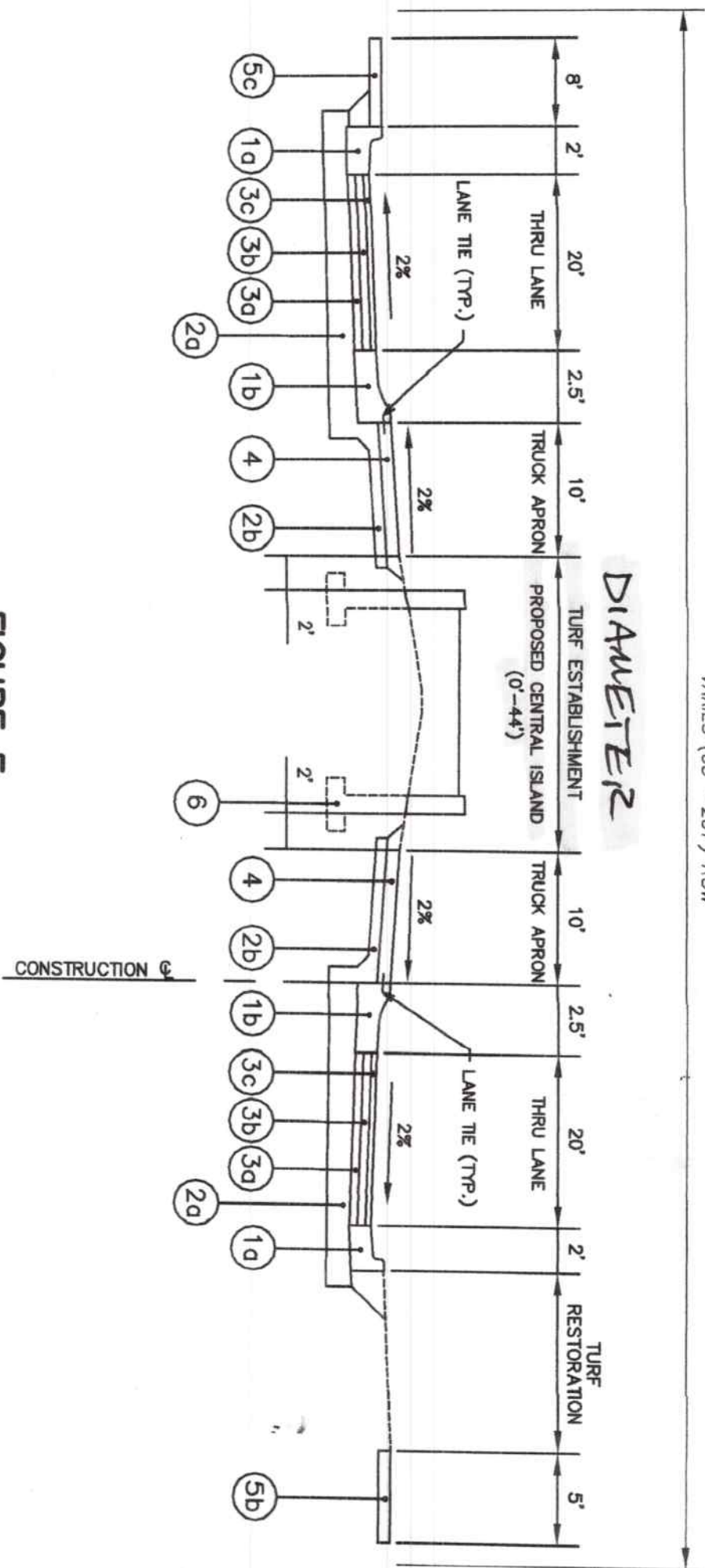
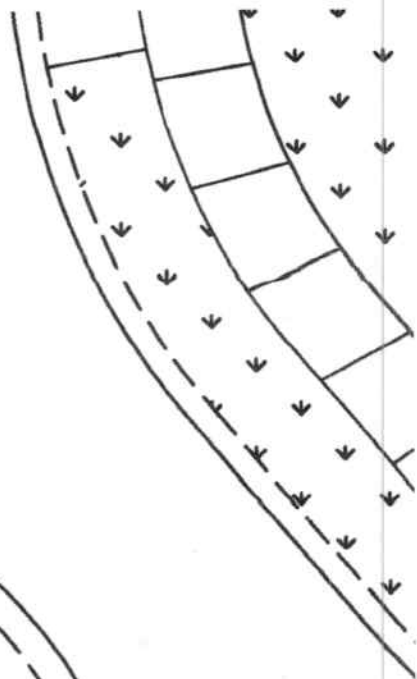
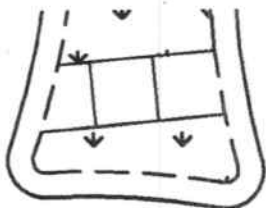
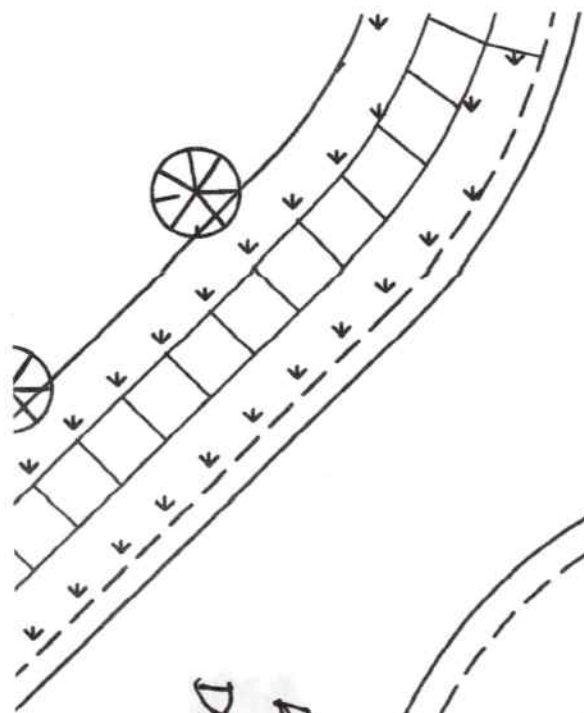
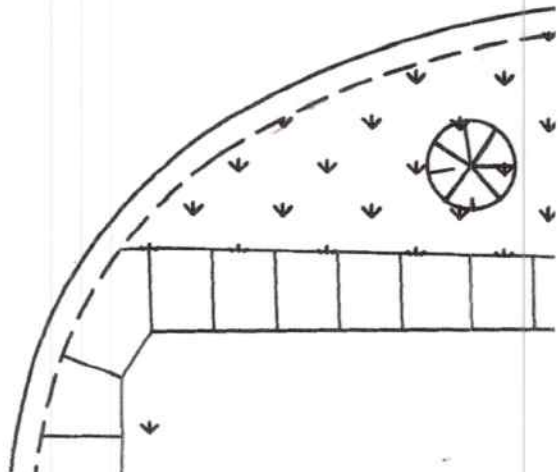
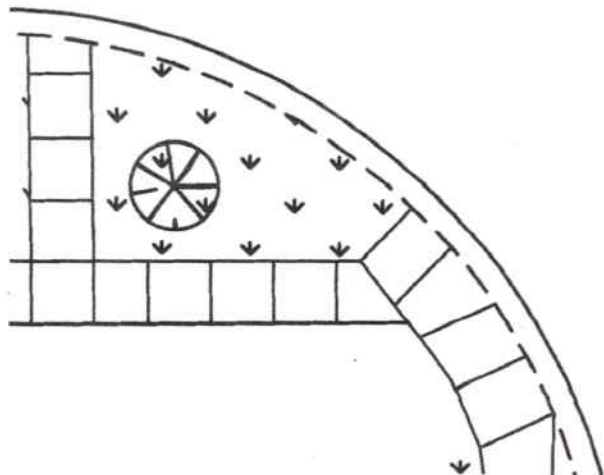
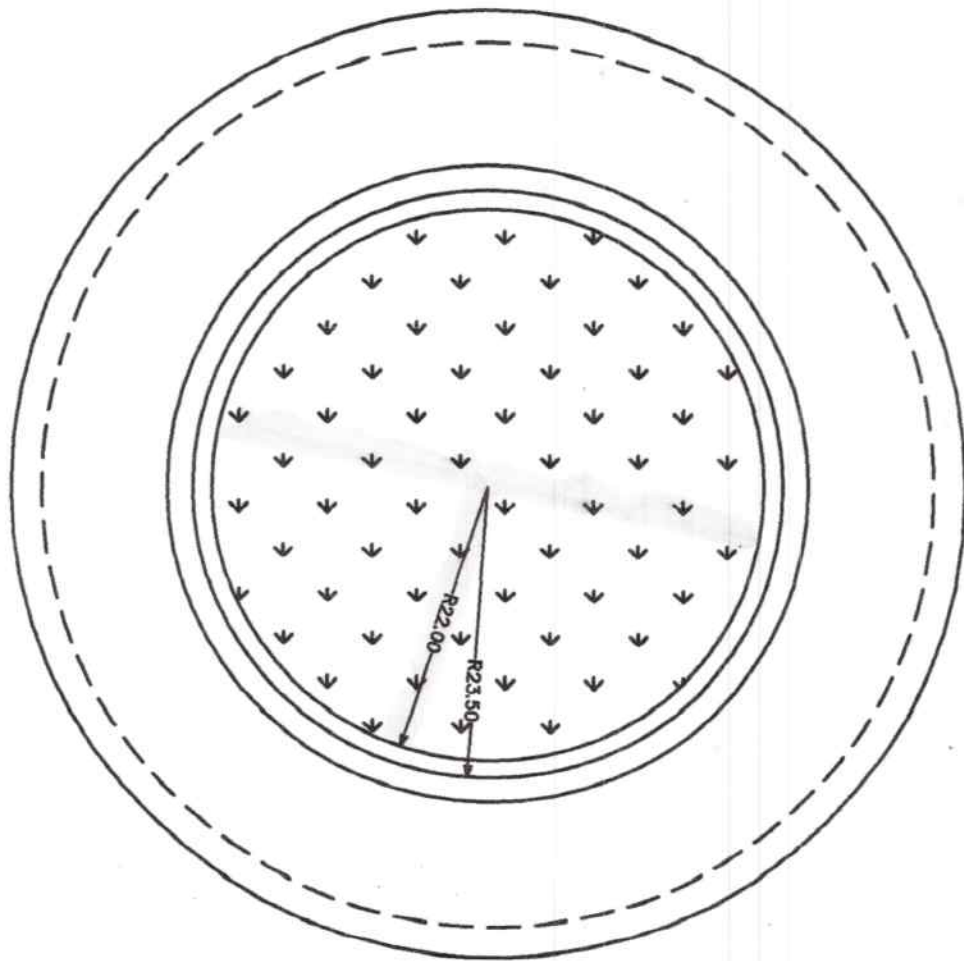

FIGURE E

TYPICAL CROSS SECTION OF PROPOSED CONSTRUCTION
STA 101+66 TO STA 102+85
ON MARTIN LUTHER KING JR DRIVE
STA 12+28 TO STA 13+64
ON MORRELL STREET



RADIUS = 22'
 DIAMETER = 44'



ORIGINAL SCULPTURE DESIGN

#7

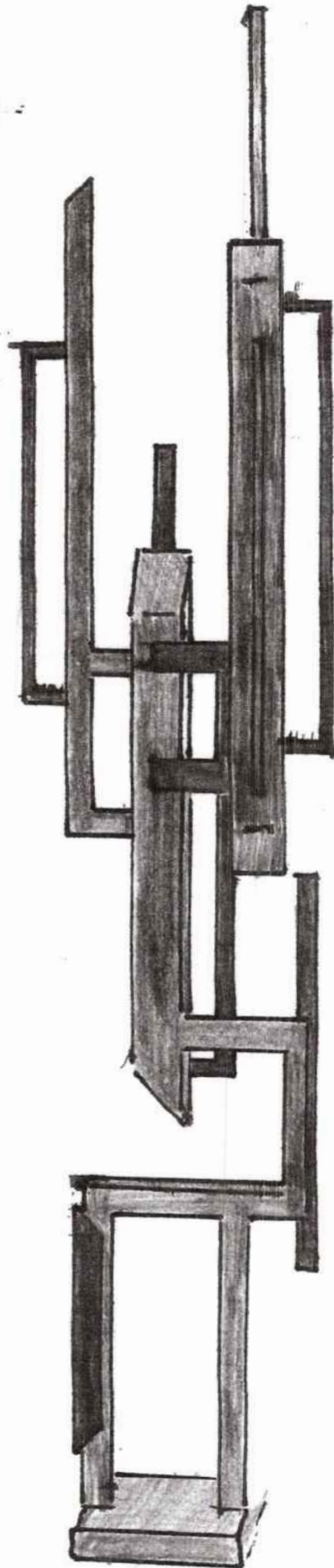

C. TURNER
2022

ORIGINAL SCULPTURE DESIGN

#2

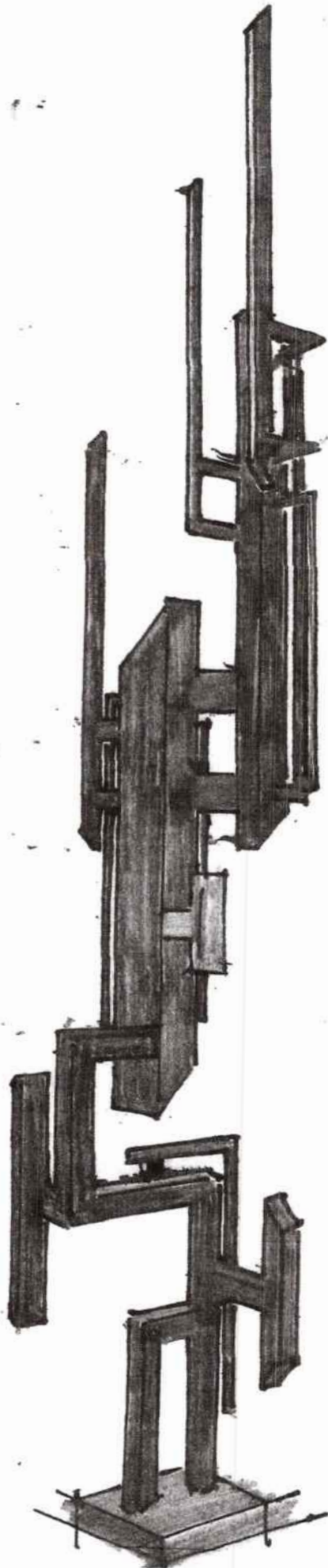

C. TURNER
2022

ORIGINAL SCULPTURE DESIGN

#3

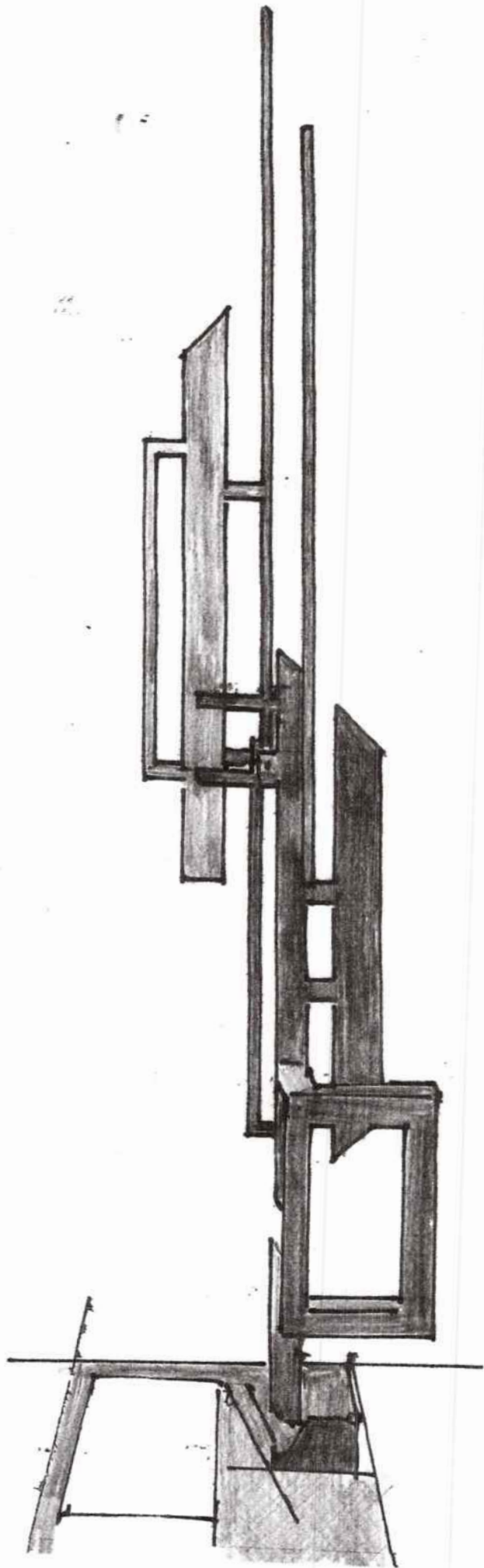

C. TURNER
2022

ORIGINAL SCULPTURE DESIGN
"A COMMUNITY OF SHAPES"

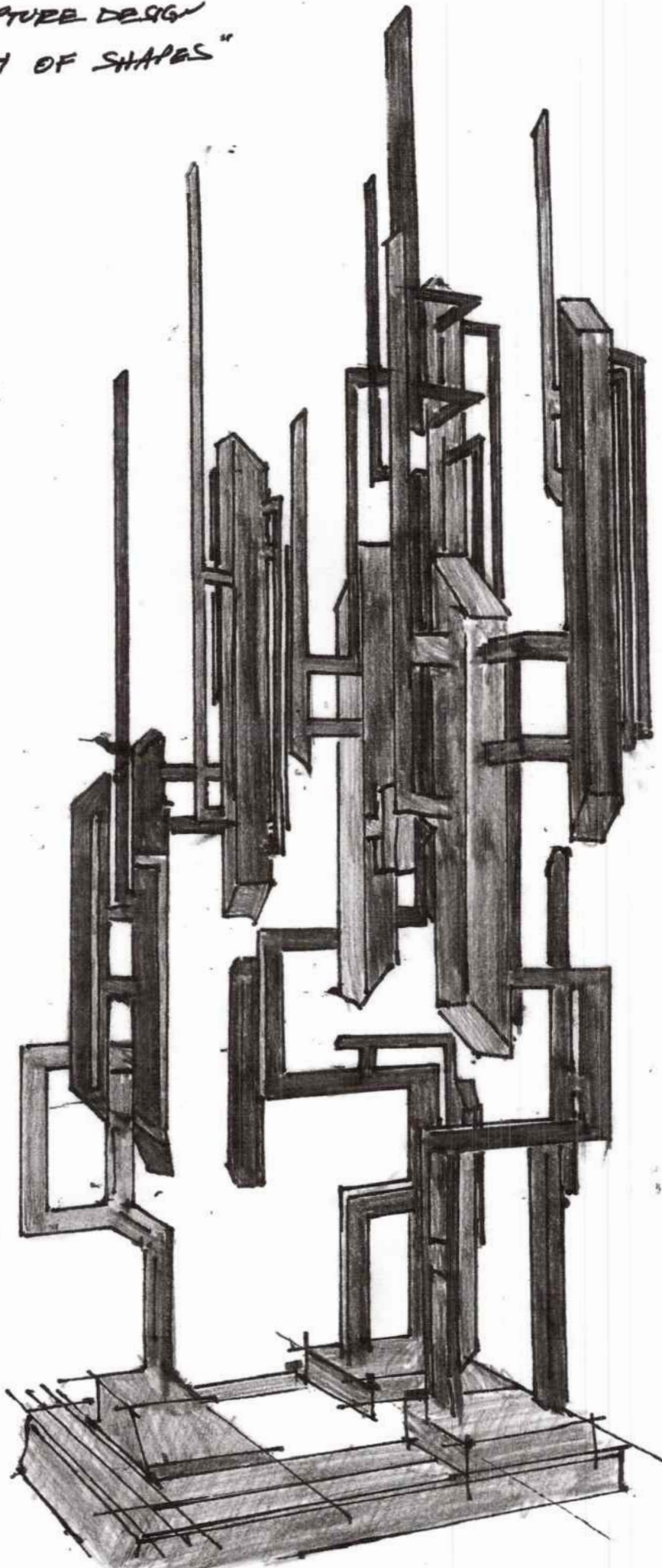

#4

C. TURNER
2022

"A COMMUNITY OF SHAPES"^u

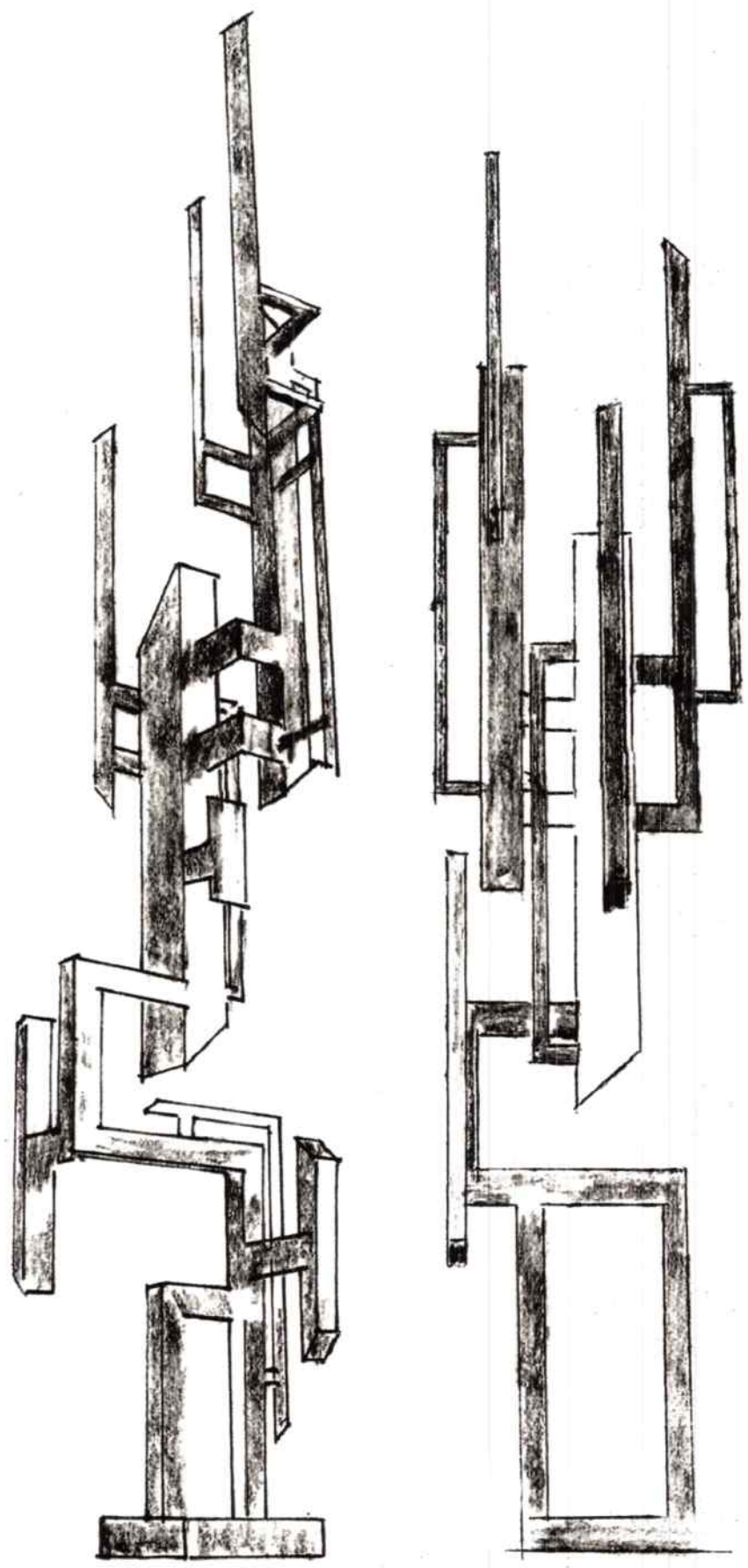

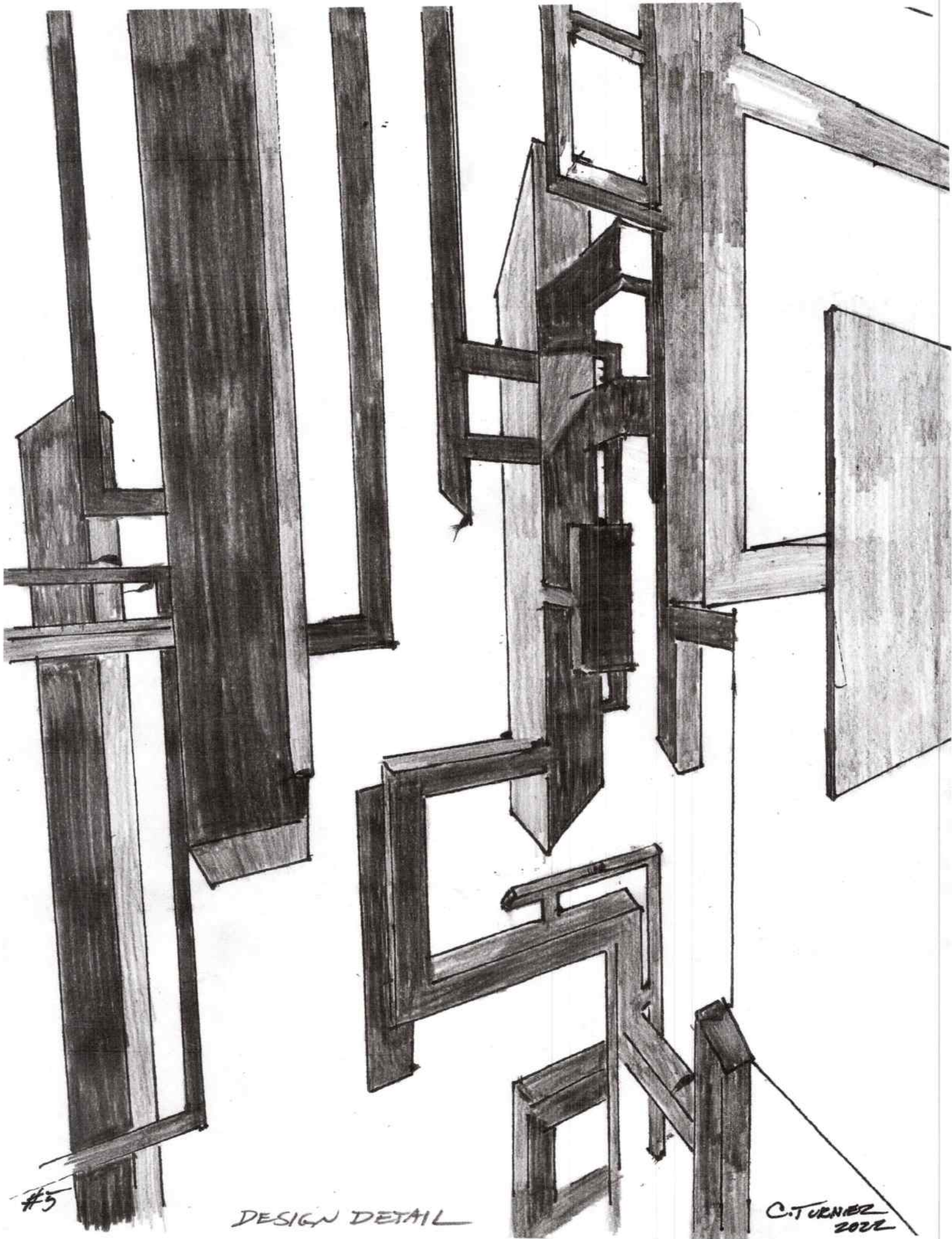

#5

DESIGN DETAIL

C. TURNER
2022

CONCEPT DRAWING
#1

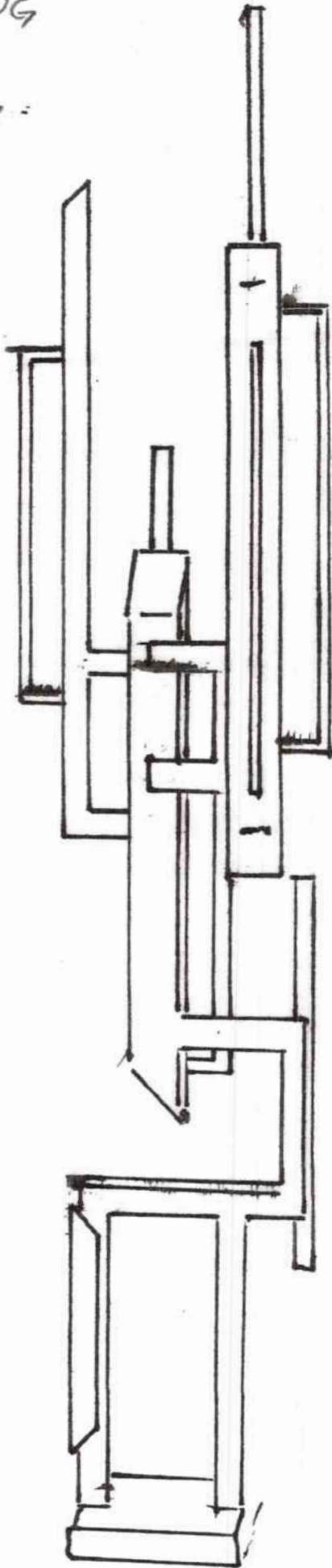

CT (E2)

CONCEPT DRAWING
#2

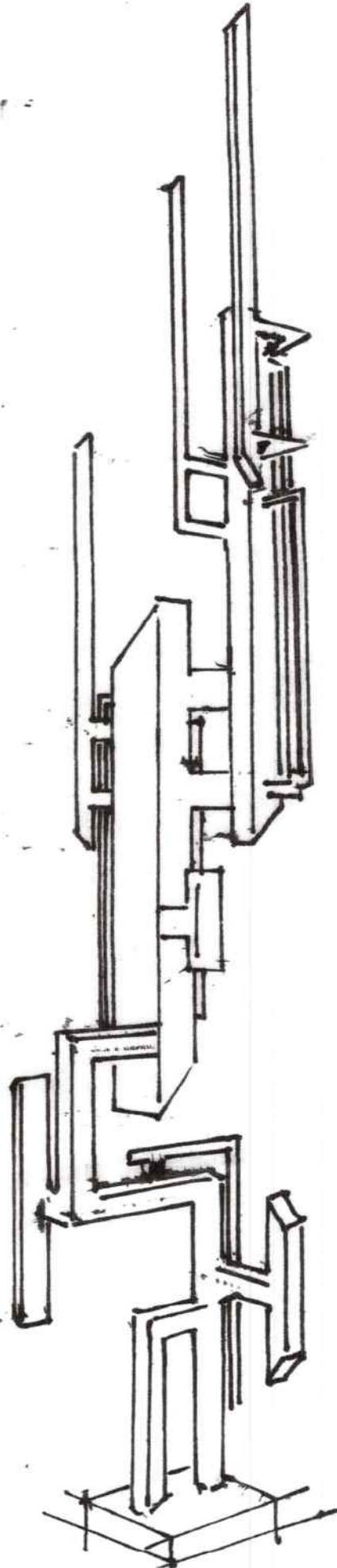

CT (22)

CONCEPT DRAWING
#3

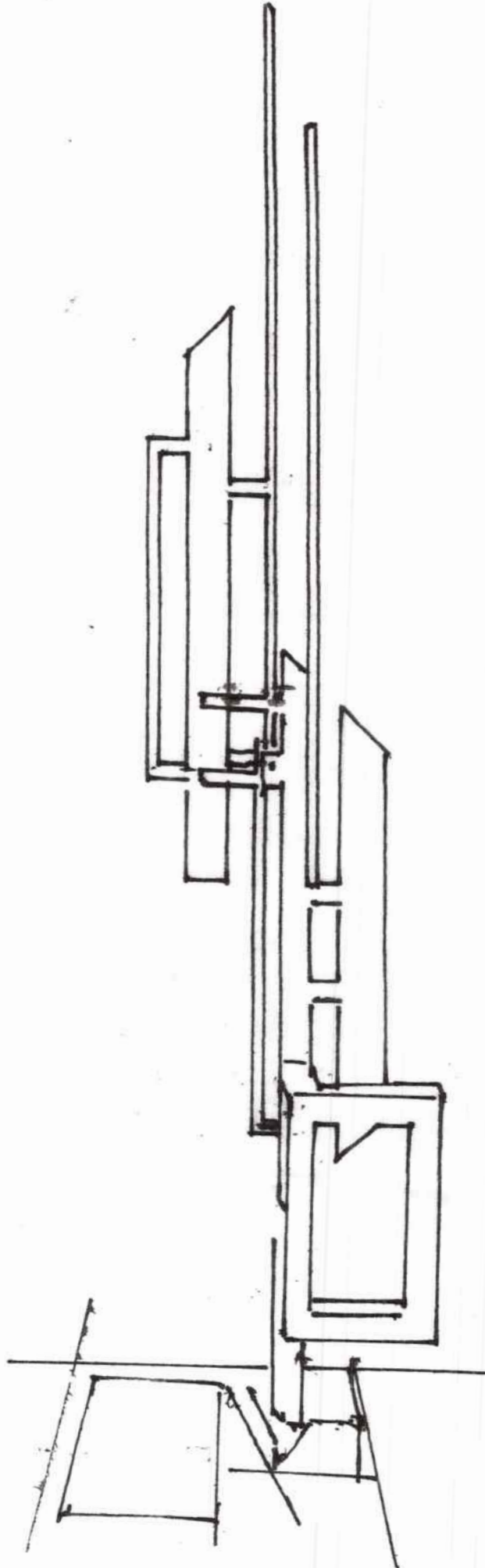

CT 22

CONCEPT DRAWING
#4

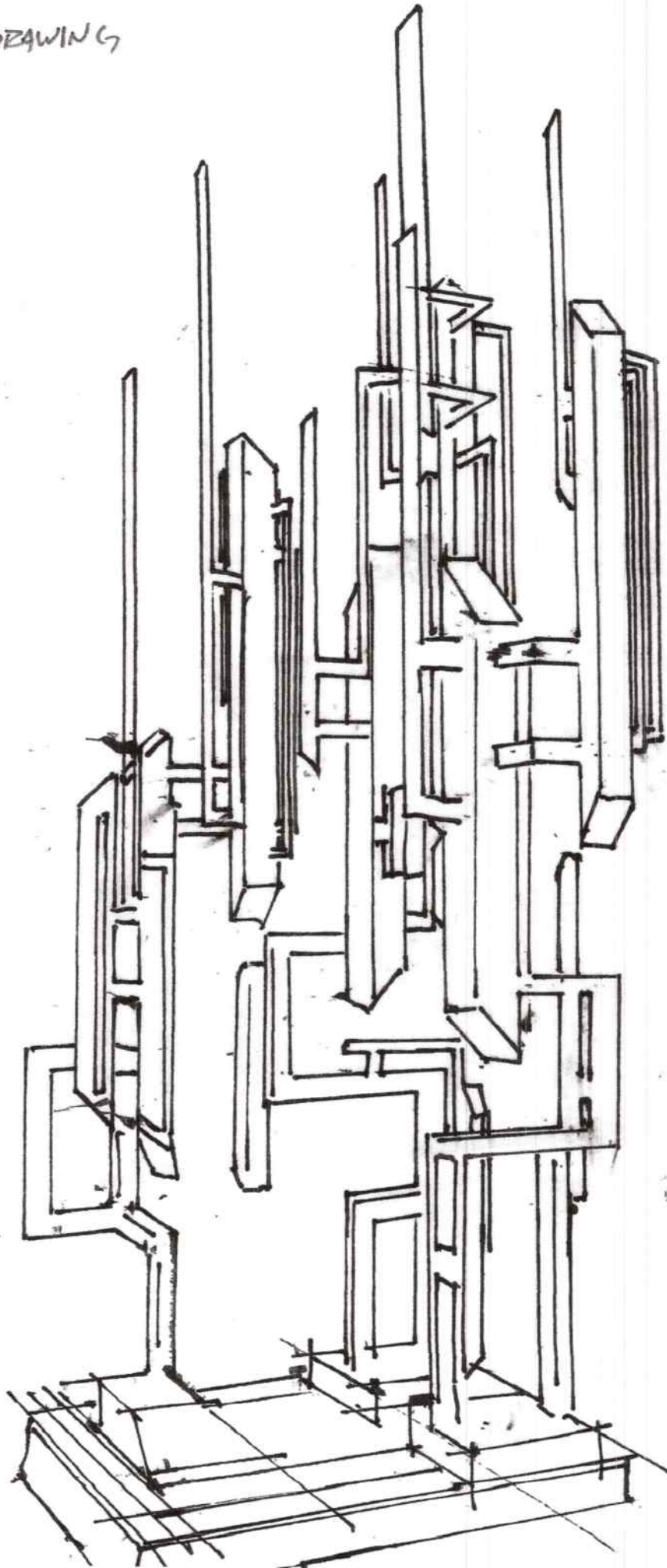

CT 22

CONCEPT DRAWING
#5

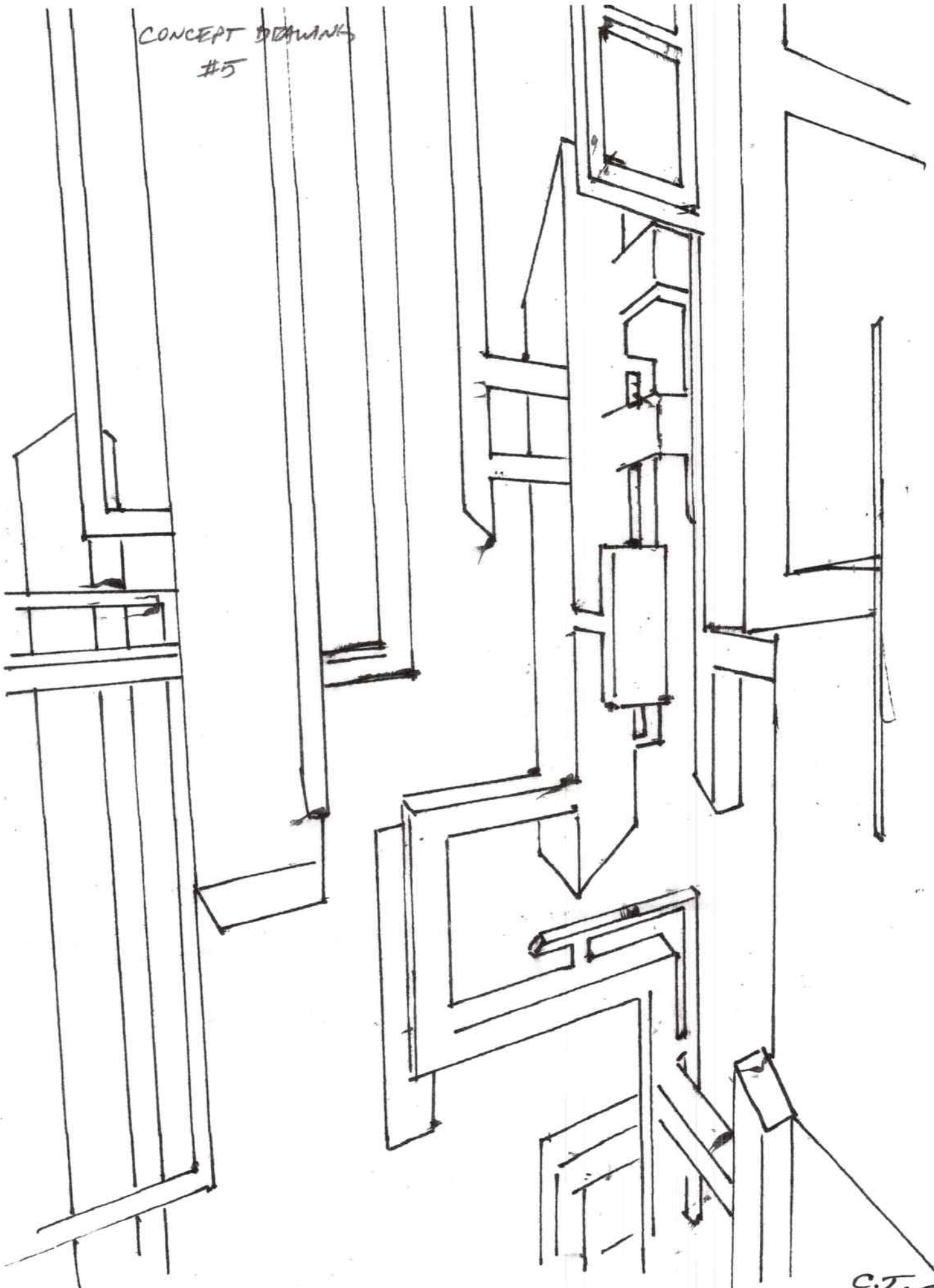

C.T. (22)